

# APPENDIX N - Seal Requirements Specified in the Approved Ventilation Plan

## ΩMEGA BLOCK SEALS

1. Seals will be hitched 6 inches into bottom and 6 inches into the ribs.
2. An approved bonding and sealant agent (i.e. "BLOCBOND" or Rite-wall) shall be used between all joints (horizontal, vertical, and in-between blocks) on all surface areas including the inby and outby walls.
3. Seals and pilaster thickness will be as indicated in sketches.
4. A gas sampling tube with a shutoff valve will be provided in the highest seal per set of seals.
5. A U-type drain will be provided for water drainage in the lowest seal per set of seals.
6. Seals will be constructed of Ωmega 384 blocks as per one of the attached three drawings.
7. Ωmega 384 block seals shall be wedged to the mine roof as indicated in the sketch below.
8. All wood will be flush with the walls of seal and coated with sealant passing ASTM E162-87.

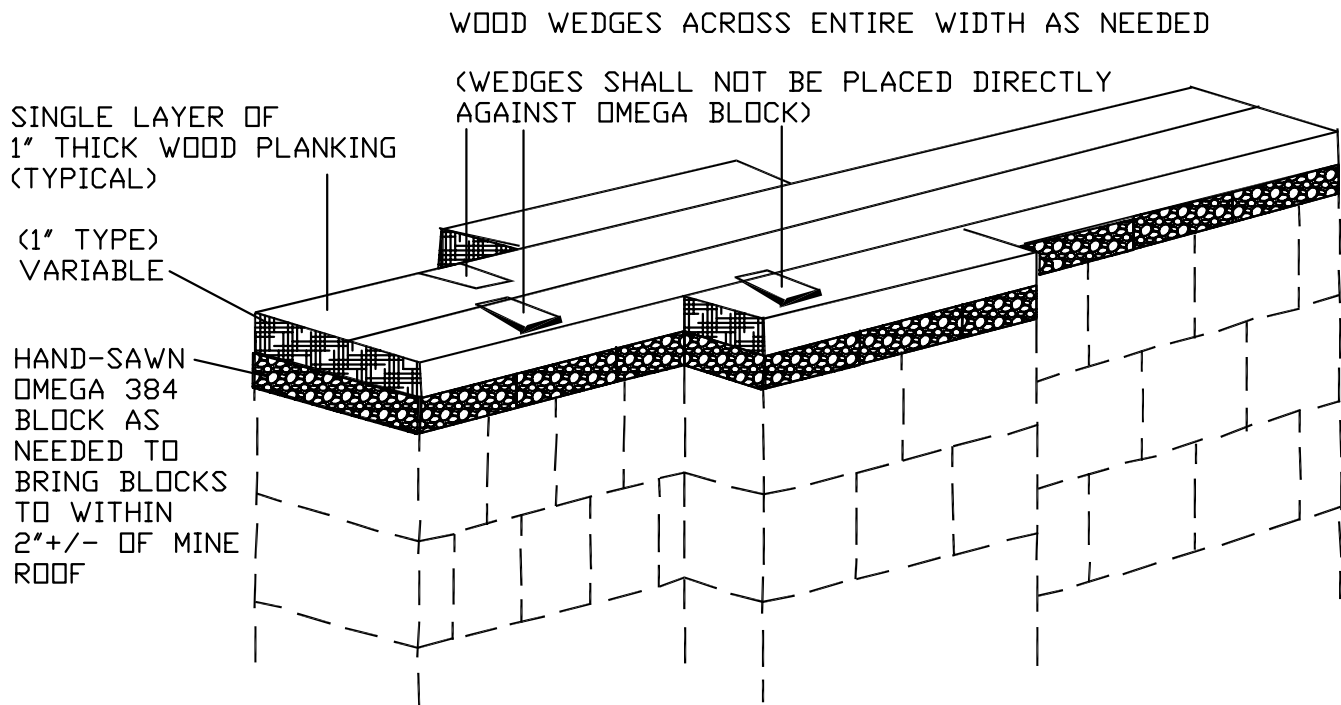

OMEGA 384 BLOCK SEAL  
ALTERNATING COURSES

